



KIT ADMISSION DIRECTE DIRECT INDUCTION KIT

RENAULT 19 16V
except models with power steering

S.A.S.
Chrono'Sport
122 rue du faubourg Saint Jean
ZA de l'AVELON - 60000 BEAUVAIS -
FRANCE
00.33.3.44.02.64.64
00.33.3.44.02.87.10

Part n° :P4

FITTING INSTRUCTION

- Remove the original air filter housing (see diagram A) .
- Remove the socket from original air filter housing and the throttle box as well as idling system (see diagram A).
- Put the Green induction kit on the throttle box and join the socket on to the sleeve (see diagram B).
- Put the small filter on the idling system (see diagram B).

NOTE : Don't forget to clean the small filter which is on the idling system.

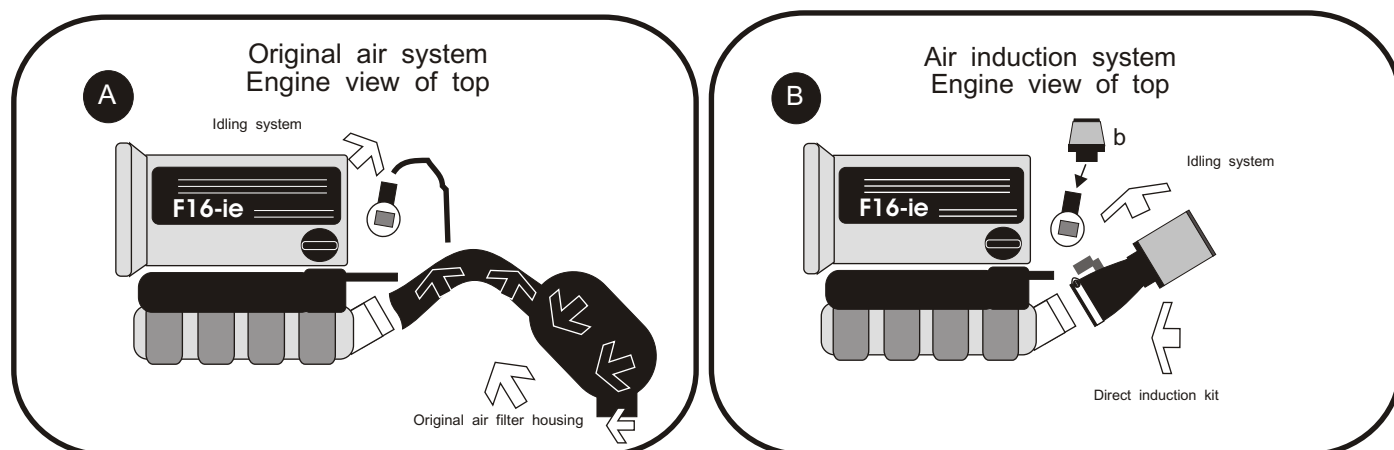

IMPORTANT:

The running of your engine is linked directly with the maintenance of the air filter. Clean your air filter every 7000 kms or 4500 miles with Green cleaning products..

WARRANTY:

The air filter guarantee is for defects in materials and workmanship only. Guarantee is void if the air filter is damaged by an accident, unreasonable use, neglect, misuse, abuse, improper installation or other causes not arising out of defects in materials and workmanship. The induction kit is a technical product so it is necessary to have some basic mechanical skills. If problems do not hesitate to have your induction kit fitted by a professional.